

Top Entry - Four Bolt Flange Style Plug Valve

This valve features an adjustable gland packing to eliminate stem leaks. The gland style Tapered Plug Valve is most commonly used in natural gas distribution systems. Lubricants/ Sealants are a mechanical component of the valve. The round bottom retains sealant and provides a membrane for the plug to travel upon. Each plug is lap fitted to its individual body to provide a reliable seal. The valve should be maintained on a regular basis to insure long term in line reliability.

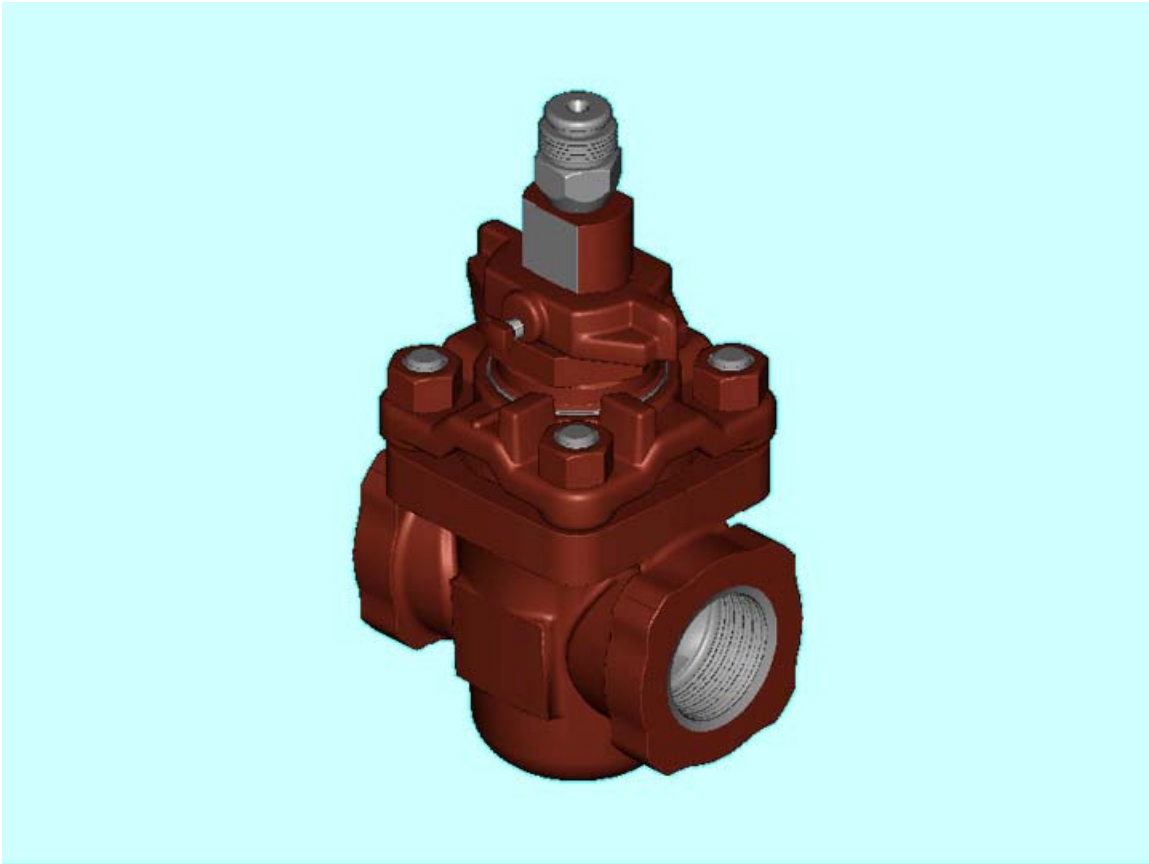

If the 3KO is not displayed properly:

- Do you have NGRain Viewer installed on your computer? If not, go to <http://www.ngrain.com/products/viewer/default.aspx>, where you can register to download a free copy.
- Did you select **Disable Macros** when you opened your document? If so, close then reopen the document and select **Enable Macros** when prompted.
- Is the security level on your computer set to **High**? If so, point to **Macro** on the **Tools** menu and then click **Security**. Set the security level to **Medium** on the **Security Level** tab and select all check boxes on the **Trusted Sources** tab.